

18' X 33'7" FIGURE-8

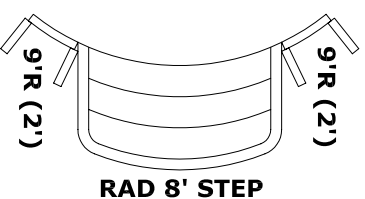
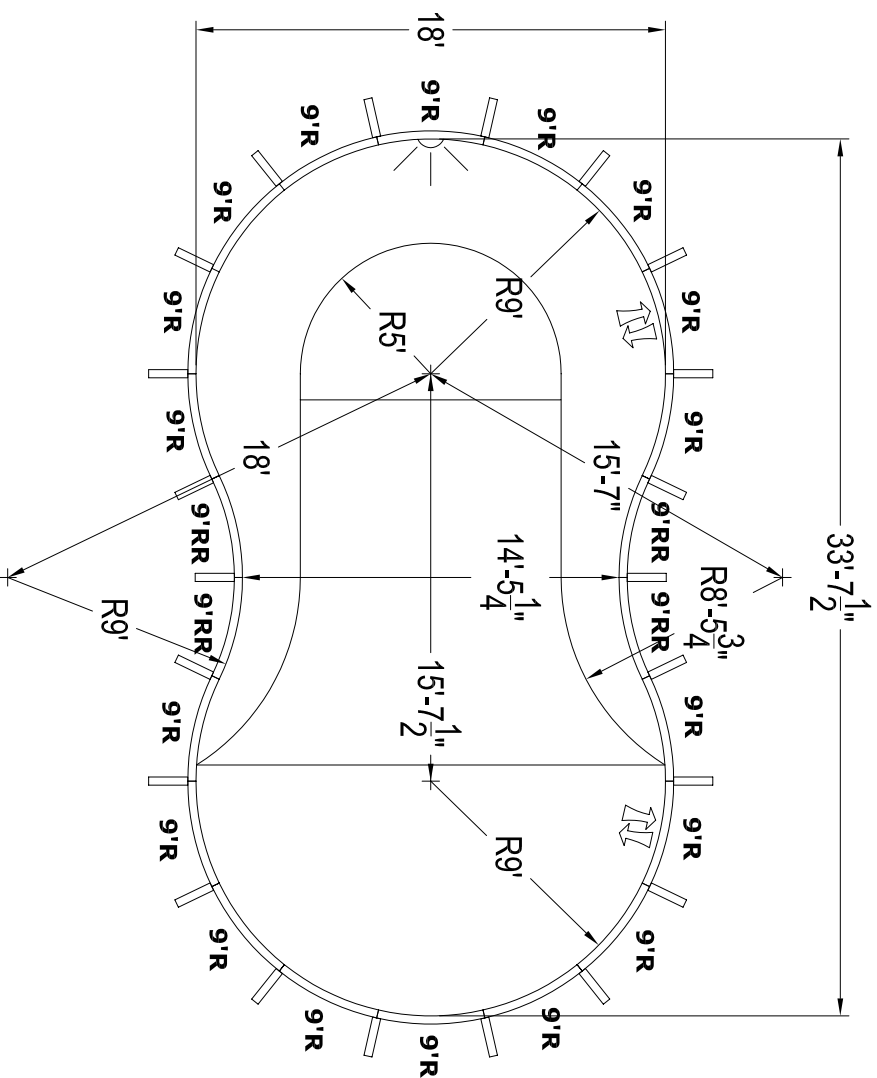

STEP BOM
-3 9' RADIUS
+2 9' R (2' OVAL INSERT)
+1 RADIUS 8' STEP

DIMENSIONS

A	18'	K	6'
B	33'7 1/2"	L	14'
D	3'4"	M	9'7 1/2"
E	4'8"	M2	-
F	8'	T	-
G	10'	S	-
H	4'	N	-
I	4'	P	-
J	4'	U	-

NSPI TYPE
PERIMETER

II
88'1.1"

AREA
CAPACITY

605
17100

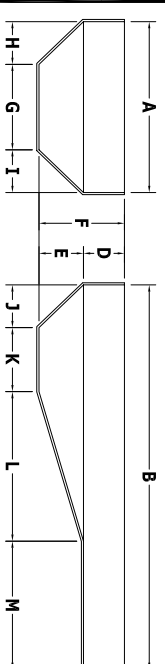

BILL OF MATERIALS

QTY	PART	DESCRIPTION
15	HP159	9R PANEL
1	HP159LL	9R PANEL (LIGHT)
2	HP159A	9R PANEL (A/G)
4	HP119M	9R REVERSE
22	HP199	BRACE

PANEL SHELF DETAIL

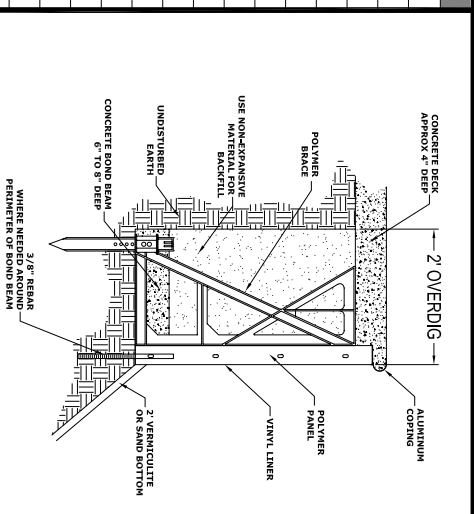

COPING LAYOUT

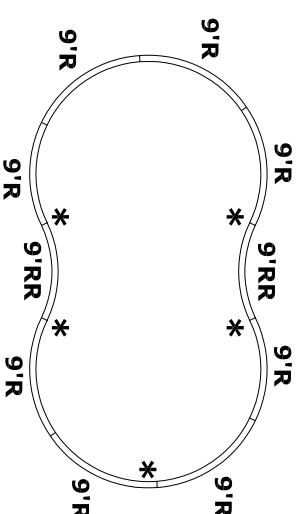

NO DIVING WARNING

ATTENTION DEALER/BUILDER:
It is your responsibility to ensure the safety package provided is delivered to the pool owner and that the "NO DIVING" labels are properly installed.

NO DIVING WARNING LABELS MUST BE INSTALLED IN NO DIVING AREAS ACCORDING TO NSPI SPECIFICATIONS



* SUGGESTED LABEL LOCATIONS ARE SPECIFIED IN THE COPING LAYOUT

PRE-CUT PANEL LEGEND

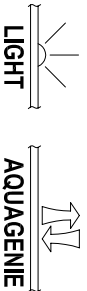

GENERAL NOTES

1. These are finished dimensions ready for the liner.
2. Dimensions are from inside pool panels.
3. The water level should be no more than 6" below the coping receptor (hanging) slot.

EXCAVATION NOTES

1. Rough excavation should be 2" to 3" deeper in each instance.
2. Soil to have minimum bearing capacity of 2000 P.S.F.
3. Locate top of pool at least 6" above surrounding land elevation.
4. See "Panel Shelf Detail" for excavation around pool.
5. Fill voids under base of panels and lamp well.
6. Backfill with non-expansive material.

ADDITIONAL NOTES

THIS DOCUMENT IS FOR ILLUSTRATIVE PURPOSES ONLY.
The dealer or contractor who sells or installs your pool is an independent contractor and is not an agent of the Manufacturer. The construction methods illustrated here are suggestions and apply only to normal ground conditions. There may be additional precautions and/or methods of construction. Proper installation is the responsibility of the dealer/builder/contractor.

DATE
JAN 2006

PANEL LINE
HYDRA

DRAWING TITLE
18' X 33'7" FIGURE-8

DRAWING NUMBER
10380



543 South Main Street - Sweetwater, TN 37874