

35'8" X 36' AMEBA

LAYOUT DIMENSIONS

A-B	41'11 1/2"
A-C	59'1 1/2"
B-C	41'8"
A-1	21'11 1/2"
A-3	13'8 3/4"
B-2	19'6"
B-3	28'4 1/4"
B-4	16'6 3/4"
C-2	22'7"
C-5	28'1"
C-6	14'11 1/2"
D-1	24'8 3/4"
D-5	15' 1/4"
1-2	34'4 3/4"
1-3	17'11 3/4"
1-4	20'7 1/4"
1-5	18'1"
1-6	23'11 1/2"
2-3	35'11 1/2"
2-4	17'11 1/2"
2-5	35'4 3/4"
2-6	17'11 3/4"
3-4	17'11 1/2"
5-6	18'1"

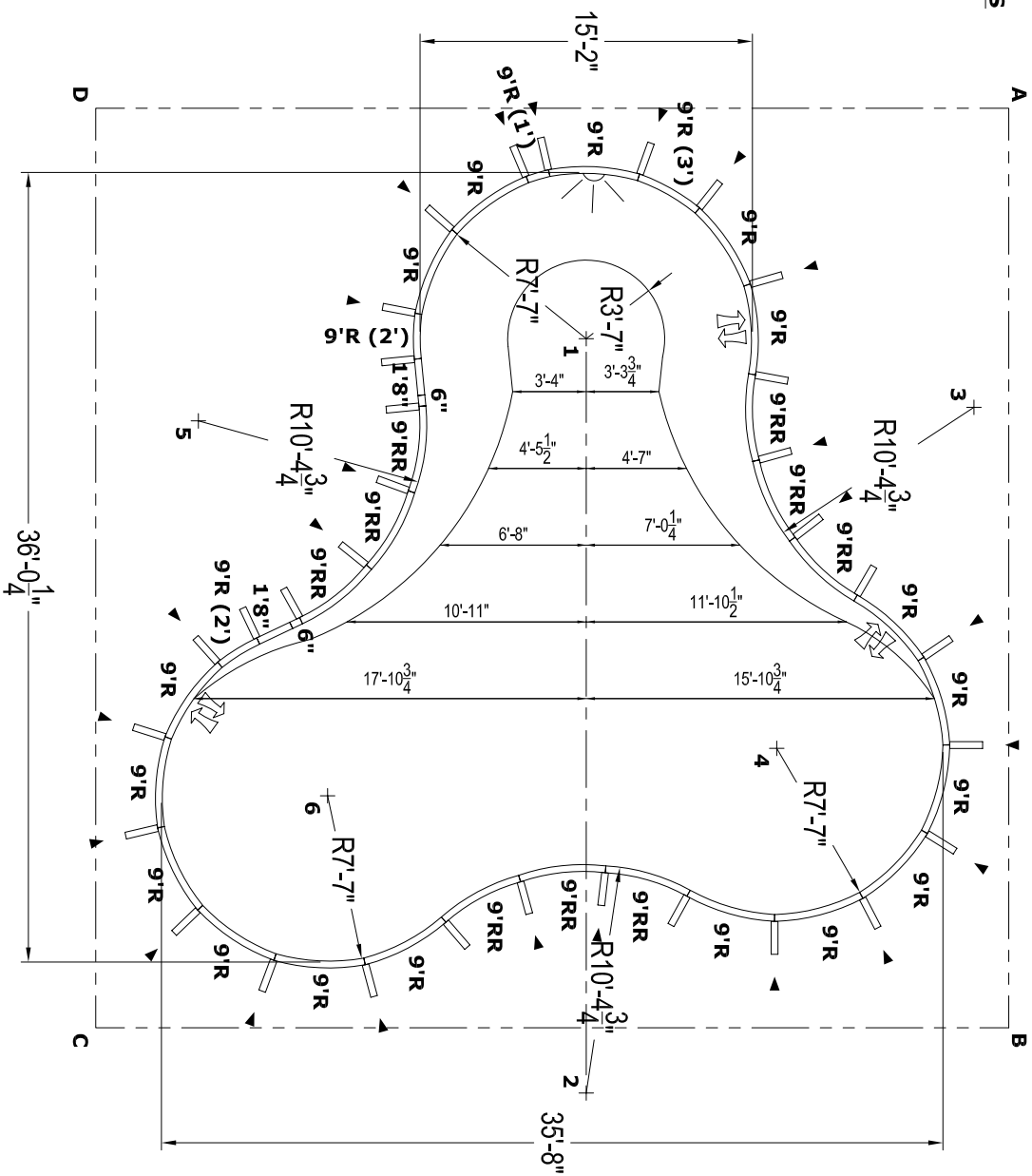

GENERAL NOTES

- These are finished dimensions ready for the liner.
- Dimensions are from inside pool panels.
- The water level should be no more than 6" below the coping receptor (hatched) slot.

EXCAVATION NOTES

- Rough excavation should be 2" to 3" deeper in each instance.
- Soil to have minimum bearing capacity of 2000 P.S.F.
- Locate top of pool at least 6" above surrounding land elevation.
- See "Panel Shelf Detail" for excavation around pool.
- Fill voids under base of panels and ramp well.
- Backfill with non-expansive material.

ADDITIONAL NOTES

THIS DOCUMENT IS FOR ILLUSTRATIVE PURPOSES ONLY. The dealer or contractor who sells or installs your pool is an independent contractor and is not an agent of the Manufacturer. The construction methods illustrated here are suggestions and apply only to normal ground conditions. There may be additional precautions and/or methods of construction. Proper installation is the responsibility of the dealer/builder/contractor.

DIMENSIONS

A	15'2"	K	6'
B	36' 1/4"	L	14'
D	3'4"	M	VAR
E	4'8"	M2	-
F	8'	T	35'8"
G	7'2"	S	-
H	4'	N	-
I	4'	P	-
J	4'	U	-

NSPI TYPE
PERIMETER

II
117'7"

AREA
CAPACITY

1282
25586

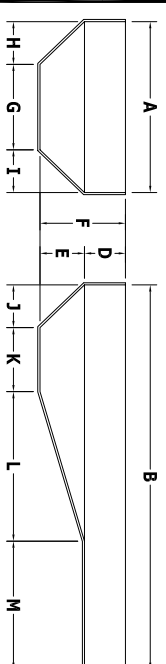

BILL OF MATERIALS

QTY	PART	DESCRIPTION
2	HP116	18" SPECIAL PANEL
2	HP111	6" FILLER PANEL
13	HP159	9R PANEL
1	HP159LL	9R PANEL (LIGHT)
3	HP159A	9R PANEL (A/G)
1	HP125	(9R) 3 ROMAN INSERT
2	HP110	(9R) 2 OVAL INSERT
1	HP115	(9R) 1 OVAL INSERT
9	HP119M	9R REVERSE
24	HP126	5" WEDGE
32	HP199	BRACE

PANEL SHELF DETAIL

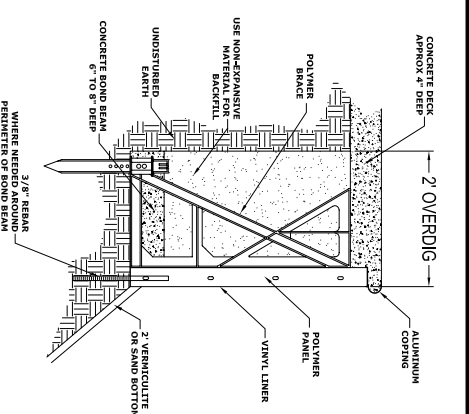

COPING LAYOUT

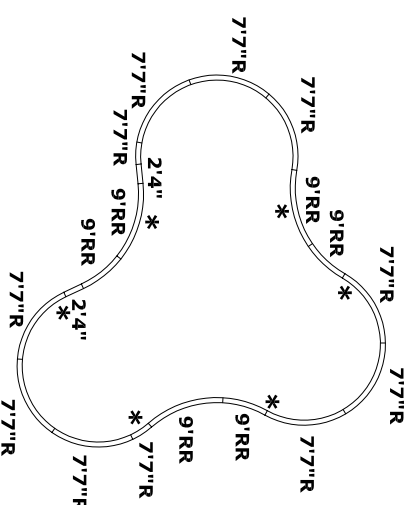

NO DIVING WARNING

ATTENTION DEALER/BUILDER: It is your responsibility to ensure the safety package provided is delivered to the pool owner and that the "NO DIVING" labels are properly installed.

NO DIVING WARNING LABELS MUST BE INSTALLED IN NO DIVING AREAS ACCORDING NSPI SPECIFICATIONS



* SUGGESTED LABEL LOCATIONS ARE SPECIFIED IN THE COPING LAYOUT

PRE-CUT PANEL LEGEND

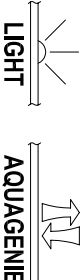

GENERAL NOTES

- These are finished dimensions ready for the liner.
- Dimensions are from inside pool panels.
- The water level should be no more than 6" below the coping receptor (hatched) slot.

EXCAVATION NOTES

- Rough excavation should be 2" to 3" deeper in each instance.
- Soil to have minimum bearing capacity of 2000 P.S.F.
- Locate top of pool at least 6" above surrounding land elevation.
- See "Panel Shelf Detail" for excavation around pool.
- Fill voids under base of panels and ramp well.
- Backfill with non-expansive material.

ADDITIONAL NOTES

THIS DOCUMENT IS FOR ILLUSTRATIVE PURPOSES ONLY. The dealer or contractor who sells or installs your pool is an independent contractor and is not an agent of the Manufacturer. The construction methods illustrated here are suggestions and apply only to normal ground conditions. There may be additional precautions and/or methods of construction. Proper installation is the responsibility of the dealer/builder/contractor.



543 South Main Street - Sweetwater, TN 37874

DATE: JAN 2006
PANEL LINE: HYDRA
DRAWING TITLE: 35'8" X 36' AMEBA

DRAWING NUMBER: 10950